

# C6Amodul / C6Amodul K

AWG 26/1 - 22/1, AWG 26/7 - 22/7

9430/899425

i HINWEIS / NOTE / NOTICE	
	<p><b>de</b> Anschlussfehler vermeiden! Vor dem Anschluss Montageanleitung sorgfältig lesen!</p> <p><b>en</b> Avoid connection errors! Read installation instructions carefully before connecting!</p> <p><b>fr</b> Eviter des erreurs de raccordement ! A lire attentivement avant de procéder au raccordement !</p>

- de** Montagehinweis für den Installateur
- en** Mounting note for the installer
- fr** Notice d'installation pour l'installateur

**Modul**  
130B11-E 180°



**Keystone**  
130B21-E 180°

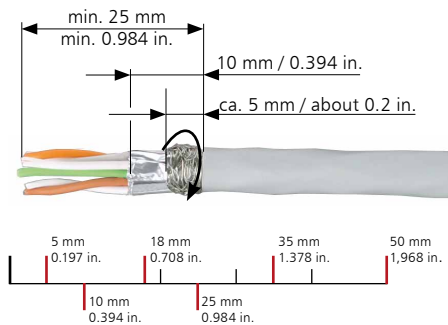

i HINWEIS / NOTE / NOTICE	
<b>de</b>	<b>Kabel AWG 26!</b> Schirmgeflecht 5 mm über den Kabelmantel aufbringen.
<b>en</b>	<b>Cable AWG 26!</b> Wrap the braided shield 5 mm over the cable sheath.
<b>fr</b>	<b>Câble AWG 26 !</b> Enrouler le blindage tressé 5 mm autour du gainage.

**Anschlussbelegung / PIN assignments  
Affectation des brins**

PIN Nr. / No.	T568A	T568B
1	WH-GN	WH-OG
2	GN	OG
3	WH-OG	WH-GN
4	BU	BU
5	WH-BU	WH-BU
6	OG	GN
7	WH-BN	WH-BN
8	BN	BN

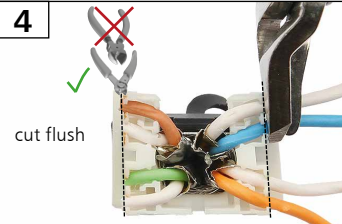
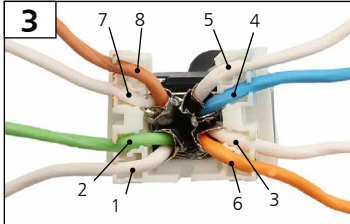
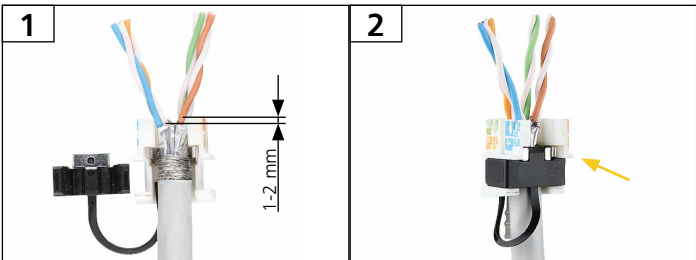

**! Nicht schräg einstecken!  
Do not plug diagonally!  
Ne pas insérer en diagonal !**

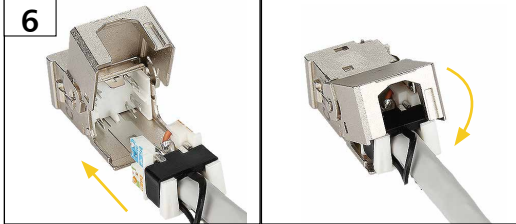

- (de) Schließen des Moduls bei Verwendung von Werkzeug
- (en) Closing the module by using a tool
- (fr) Fermeture du module en utilisant un outil

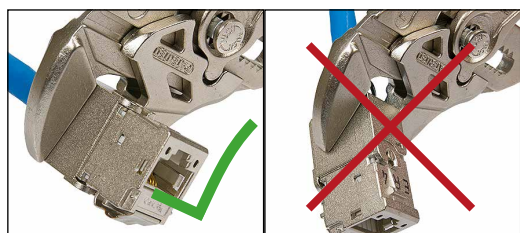

- (de) Demontage
- (en) Disassembly
- (fr) Démontage

- (de) Potentialausgleich
- (en) Potential equalisation
- (fr) Compensation de potentiel

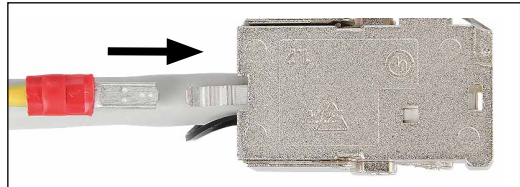
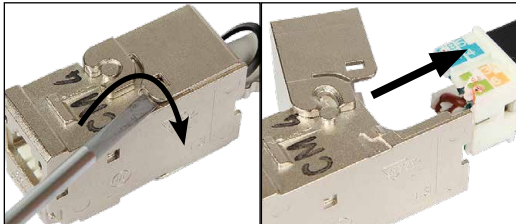

Optionaler Potentialausgleich mit 2,8 mm Flachstecker  
Optional potential equalisation with 2.8 mm flat plug  
Compensation de potentiel optionnelle par languette à 2,8 mm